

Specifications:

Current Rating: 1.0A AC/DC
 Voltage rating: 125V AC/DC
 Temperature range: -25°C to +85°C
 Contact resistance: 20mΩ max.
 Insulation resistance: 100M min.
 Withstand voltage: 500V AC/minute
 Package: 1500pcs / reel

Circuits	Dimensions (mm)		
	A	B	C
2	1.25	3.10	7.30
3	2.50	4.35	8.60
4	3.75	5.60	9.80
5	5.00	6.85	11.10
6	6.25	8.10	12.30
7	7.50	9.35	13.60
8	8.75	10.60	14.90
9	10.00	11.85	16.10
10	11.25	13.10	17.30
11	12.50	14.35	18.60
12	13.75	15.60	19.85
13	15.00	16.85	21.10
14	16.25	18.10	22.35
15	17.50	19.35	23.60

Material:

Housing: LCP, UL94V-0, beige
 PIN: brass
 Solder tab: brass

Mates with: 1251WF (wire connector, female, single row)

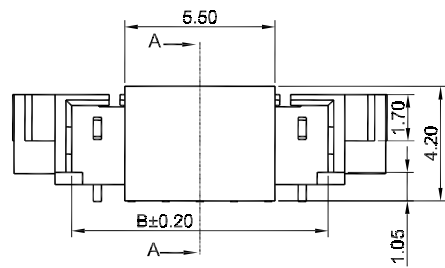

Section A-A

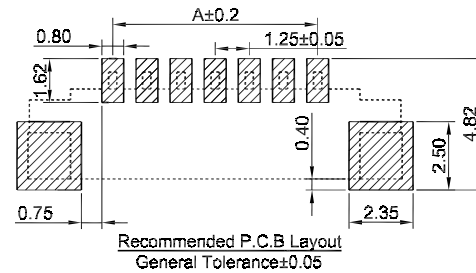
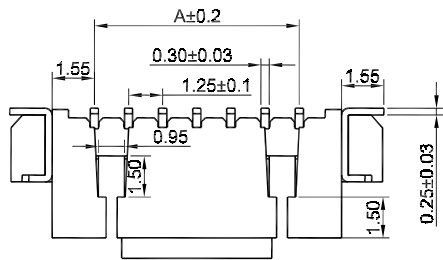
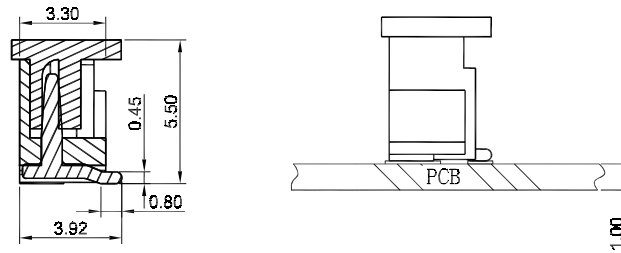

Part Number Information:

Series Number: 1251 BVS - XX 03 BG T
 BVS: Board connector, vertical, SMT type
 No. of circuits, 02 to 15
 Material: 03 -- LCP, UL94V-0
 Color: BG--beige
 Plating: T-- tin plating

							General Tolerance	Zeakka Electronics				Document No.: ZK-1251BVS		
							.X ±0.3					Title: HEADER, VERTICAL, SMT TYPE, SINGLE ROW, 1.25MM PITCH, TIN		
							.XX ±0.2	APPR	CH'K	DRWN	Date	Dimensions	Scale	Version
							.XXX ±0.1	Kai Lee	Cris Wang	Jun Wei	2020.8.7	mm	1:1	A
Date	Version	EC No.	Description	DRWN	CH'K	APPR	THIRD ANGLE PROJECTION							

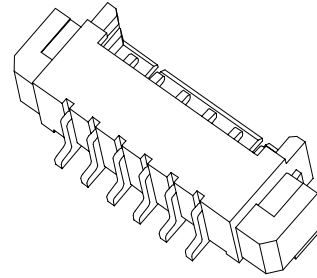
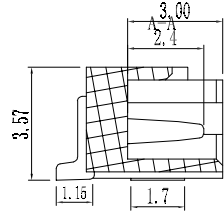
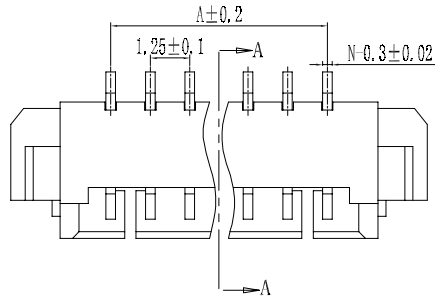

Specifications:

Current Rating: 1.0A AC/DC
 Voltage rating: 125V AC/DC
 Temperature range: -25°C to +85°C
 Contact resistance: 20mΩ max.
 Insulation resistance: 100M min.
 Withstand voltage: 500V AC/minute
 Package: 2000pcs / reel

Circuits	Dimensions (mm)			
	A	B	C	D
2	1.25	3.10	7.50	/
3	2.50	4.35	8.80	/
4	3.75	5.60	10.00	2.50
5	5.00	6.85	11.30	3.75
6	6.25	8.10	12.60	5.00
7	7.50	9.35	13.80	6.25
8	8.75	10.60	15.00	7.50
9	10.00	11.85	16.30	8.75
10	11.25	13.10	17.60	10.00
11	12.50	14.35	18.80	11.25
12	13.75	15.60	20.10	12.50
13	15.00	16.85	21.30	13.75
14	16.25	18.10	22.55	15.00
15	17.50	19.35	23.80	16.25

Material:

Housing: LCP, UL94V-0, beige
 PIN: brass
 Solder tab: brass

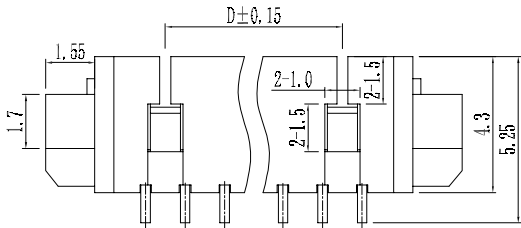

3 pin shape

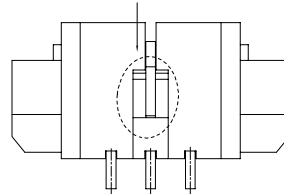

2 pin shape

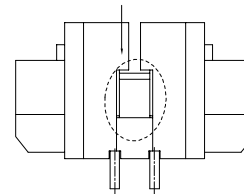

Mates with: 1251WF (wire connector, female, single row)

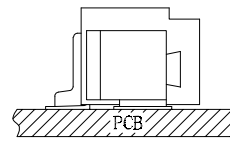
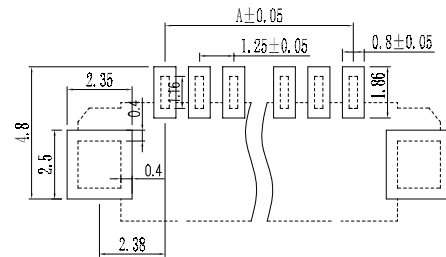
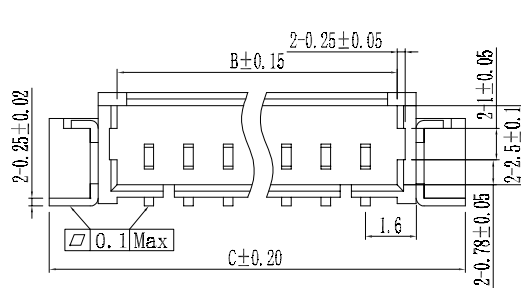

Part Number Information:

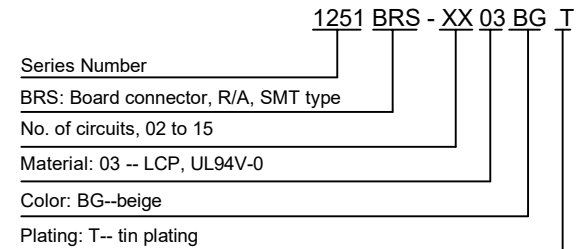

							General Tolerance	Zeakka Electronics				Document No.:	ZK-1251BRS					
							.X ± 0.3					Title:	HEADER, R/A, SMT TYPE, SINGLE ROW, 1.25MM PITCH, TIN					
							.XX ± 0.2					APPR	CH'K	DRWN	Date	Dimensions	Scale	Version
Date	Version	EC No.	Description	DRWN	CH'K	APPR	.XXX ± 0.1	Kai Lee	Cris Wang	Jun Wei	2020.8.7	mm	1:1	A				
							THIRD ANGLE PROJECTION											

Circuits	A	B
2	1.25	4.25
3	2.50	5.50
4	3.75	6.75
5	5.00	8.00
6	6.25	9.25
7	7.50	10.50
8	8.75	11.75
9	10.00	13.00
10	11.25	14.25
11	12.50	15.50
12	13.75	16.75
13	15.00	18.00
14	16.25	19.25
15	17.50	20.50

Specifications:

Current Rating: 1.0A AC/DC
Voltage rating: 125V AC/DC
Temperature range: -25°C to +85°C
Contact resistance: 20mΩ max.
Insulation resistance: 100M min.
Withstand voltage: 500V AC/minute
Package: 1000pcs / bag

Material:

Housing: nylon 6T, UL94V-0, beige
PIN: brass

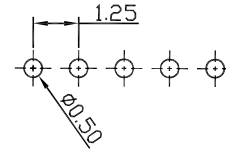
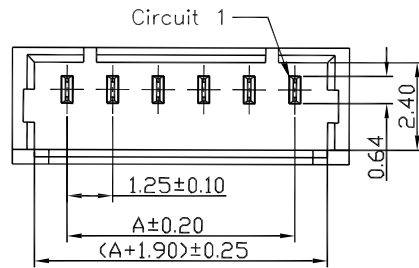

P.C.B LAYOUT

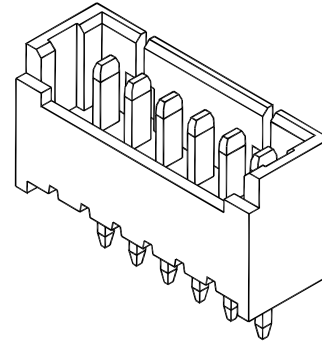

Mates with: 1251WF (wire connector, female, single row)

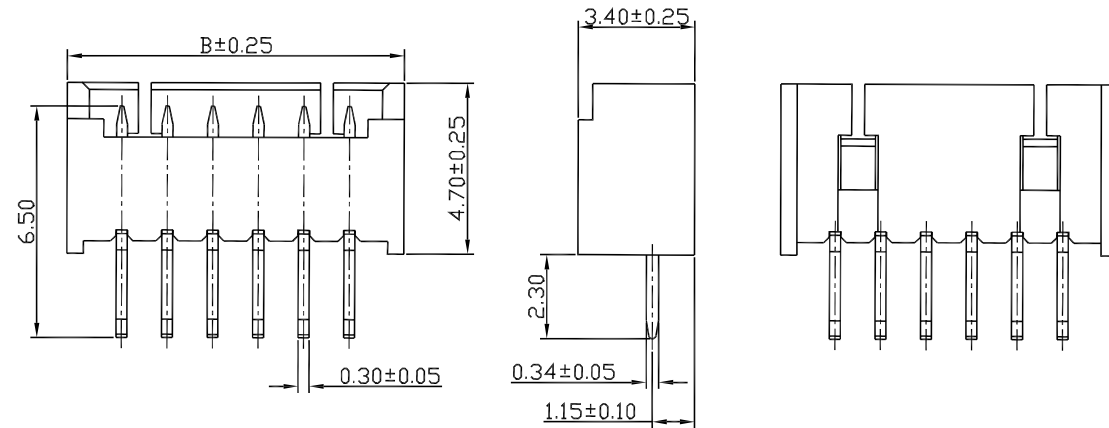

Part Number Information:

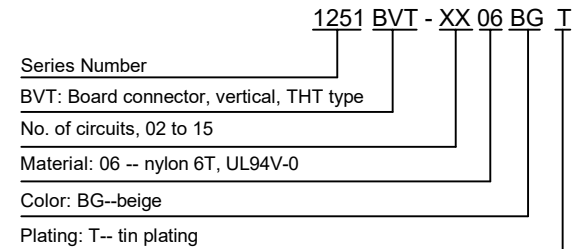

							General Tolerance	Zeakka Electronics				Document No.: ZK-1251BVT		
							.X ±0.3					Title: HEADER, VERTICAL, THT TYPE, SINGLE ROW, 1.25MM PITCH, TIN		
							.XX ±0.2	APPR	CH'K	DRWN	Date	Dimensions	Scale	Version
Date	Version	EC No.	Description	DRWN	CH'K	APPR	.XXX ±0.1	Kai Lee	Cris Wang	Jun Wei	2020.8.7	mm	1:1	A
							THIRD ANGLE PROJECTION							

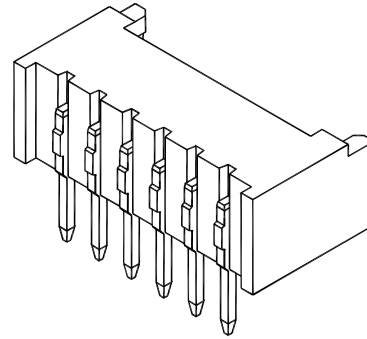
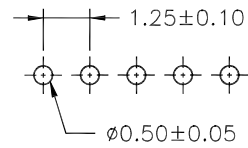
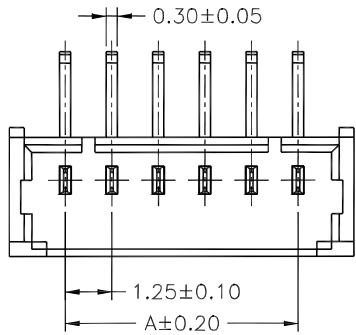

Specifications:

Current Rating: 1.0A AC/DC
 Voltage rating: 125V AC/DC
 Temperature range: -25°C to +85°C
 Contact resistance: 20mΩ max.
 Insulation resistance: 100M min.
 Withstand voltage: 500V AC/minute
 Package: 1000pcs / bag

Material:

Housing: nylon 6T, UL94V-0, beige
 PIN: brass

Circuits	A	B
2	1.25	4.25
3	2.50	5.50
4	3.75	6.75
5	5.00	8.00
6	6.25	9.25
7	7.50	10.50
8	8.75	11.75
9	10.00	13.00
10	11.25	14.25
11	12.50	15.50
12	13.75	16.75
13	15.00	18.00
14	16.25	19.25
15	17.50	20.50

Mates with: 1251WF (wire connector, female, single row)

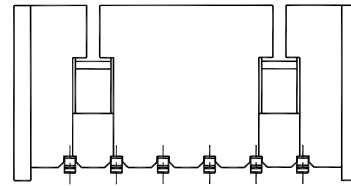
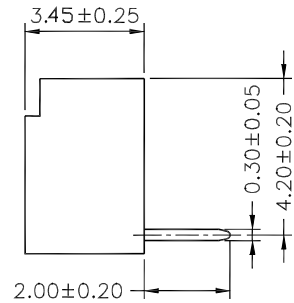
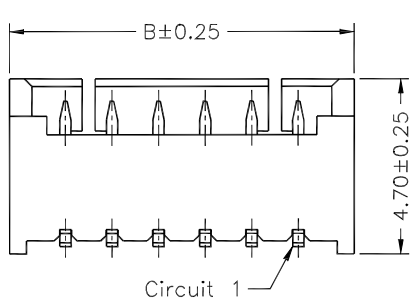

Part Number Information:

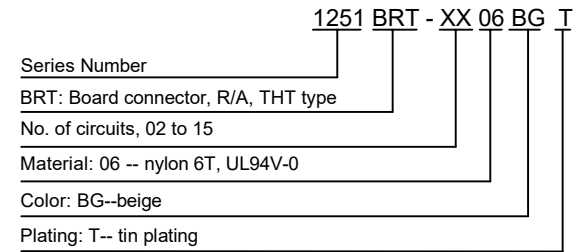

Date	Version	EC No.	Description	DRWN	CH'K	APPR	General Tolerance	Zeakka Electronics				Document No.:	ZK-1251BRT	
							.X ±0.3	APPR	CH'K	DRWN	Date	Dimensions	Scale	Version
							.XX ±0.2	Kai Lee	Cris Wang	Jun Wei	2020.8.7	mm	1:1	A
							.XXX ±0.1							
							THIRD ANGLE PROJECTION							

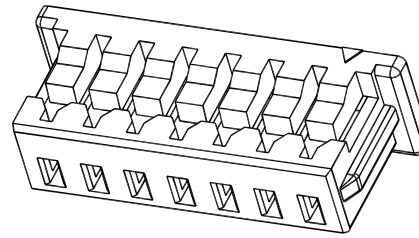
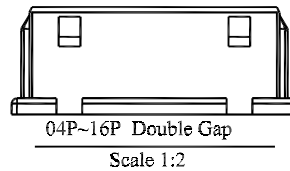
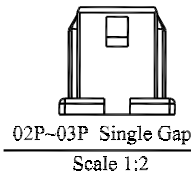
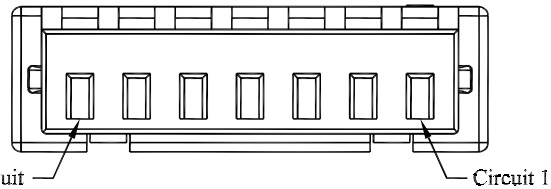
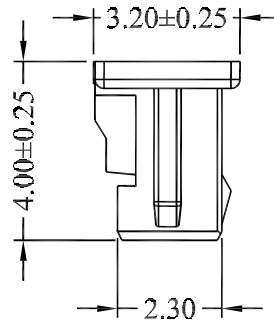
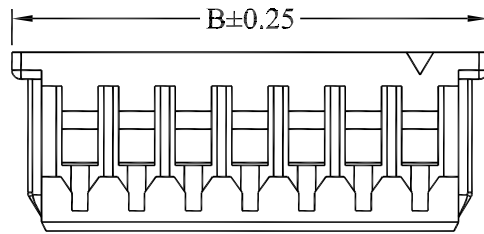
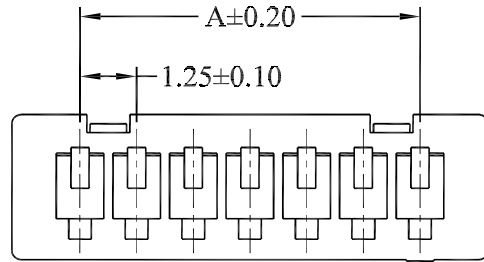

Specifications:

Current Rating: 1.0A AC/DC
 Voltage rating: 125V AC/DC
 Temperature range: -25°C to +85°C
 Contact resistance: 20mΩ max.
 Insulation resistance: 100M min.
 Withstand voltage: 500V AC/minute
 Package: 1000pcs / bag

Material:

Housing: nylon 66, UL94V-0, white

Mates with: 1251BVT (header, vertical, THT type)
 1251BRT (header, R/A, THT type)
 1251BVS (header, vertical, SMT type)
 1251BRS (header, R/A, SMT type)
 1251WM (housing, male)

Used with: 1251TF-PT (female terminal)

Part Number Information:

1251 WF - XX 00 WH
 Series Number
 WF: wire connector, female
 No. of circuits, 02 to 15
 Material: 00-- nylon 66, UL94V-0
 Color: WH -- white

Circuits	A	B
2	1.25	4.25
3	3.75	5.50
4	5.00	6.75
5	6.25	8.00
6	7.50	9.25
7	8.75	10.50
8	10.00	11.75
9	11.25	13.00
10	12.50	14.25
11	13.75	15.50
12	15.00	16.75
13	16.25	18.00
14	17.50	19.25
15	18.75	20.50

							General Tolerance	Zeakka Electronics				Document No.: ZK-1251WF		
							.X ±0.3					Title: HOUSING, FEMALE, CRIMP TYPE, SINGLE ROW, 1.25MM PITCH		
							.XX ±0.2	APPR	CH'K	DRWN	Date	Dimensions	Scale	Version
							.XXX ±0.1	Kai Lee	Cris Wang	Jun Wei	2020.8.7	mm	1:1	A
Date	Version	EC No.	Description	DRWN	CH'K	APPR	THIRD ANGLE PROJECTION							
							☉							

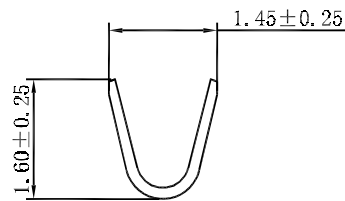
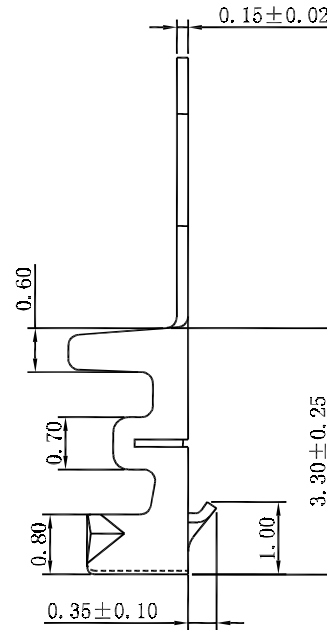
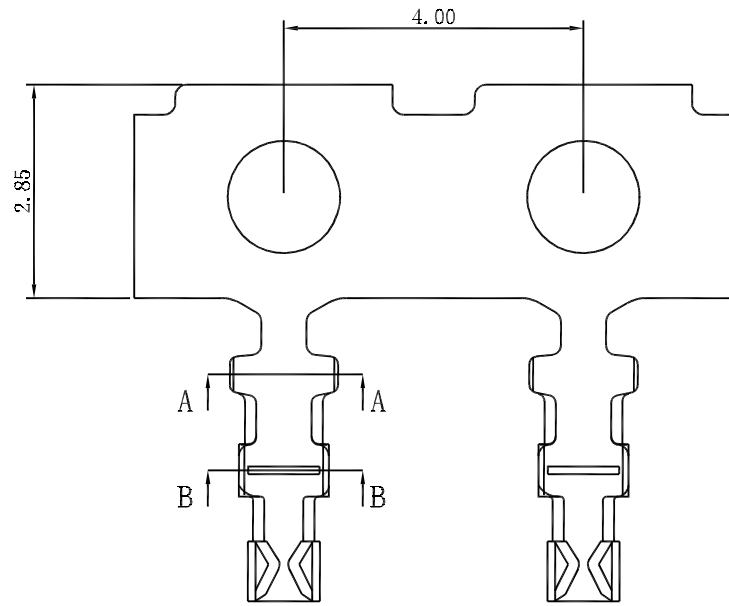

A-A

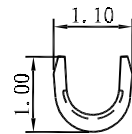

B-B

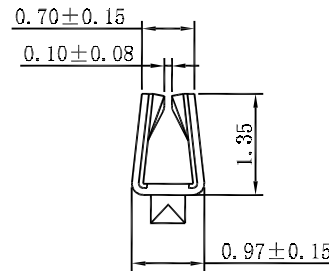

Specifications:

Current Rating: 1.0A AC/DC
 Voltage rating: 125V AC/DC
 Temperature range: -25°C to +85°C
 Contact resistance: 20mΩ max.
 Insulation resistance: 100M min.
 Withstand voltage: 500V AC/minute
 Applicable wire: AWG30 - AWG26
 Insulation OD: max 1.0mm
 Package: 20000pcs / reel

Material:

Phosphor bronze

Used with: 1251WF (female housing)

Part Number Information:

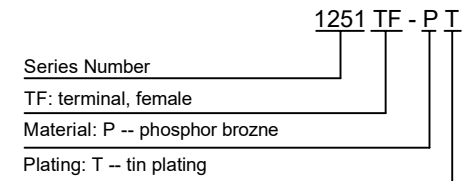

							General Tolerance	Zeakka Electronics				Document No.: ZK-1251TF			
							.X ±0.3					Title: TERMINAL, FEMALE, CRIMP TYPE, PHOSPHOR BRONZE, TIN, REEL			
							.XX ±0.2					APPR	CH'K	DRWN	Date
Date	Version	EC No.	Description	DRWN	CH'K	APPR	.XXX ±0.1	THIRD ANGLE PROJECTION	Kai Lee	Cris Wang	Jun Wei	2020.8.7	mm	1:1	A

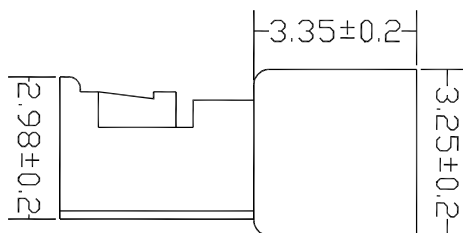
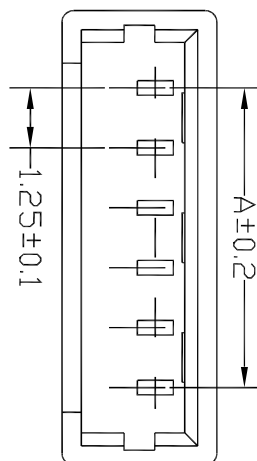
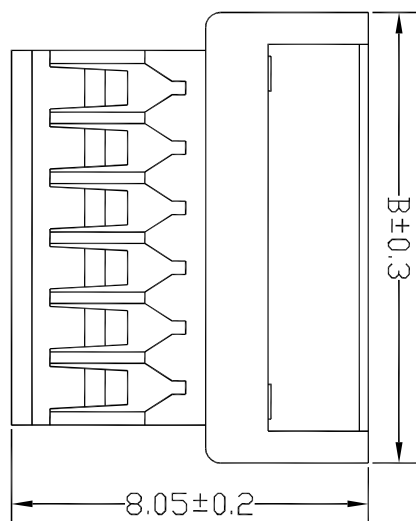

Specifications:

Current Rating: 1.0A AC/DC
 Voltage rating: 125V AC/DC
 Temperature range: -25°C to +85°C
 Contact resistance: 20mΩ max.
 Insulation resistance: 100M min.
 Withstand voltage: 500V AC/minute
 Package: 1000pcs / bag

Material:

Housing: nylon 66, UL94V-0, white

Mates with: 1251WF (housing, female)

Used with: 1251TM-PT (male terminal)

Part Number Information:

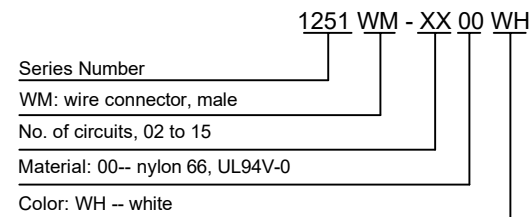

Circuits	A	B
2	1.25	4.25
3	2.50	5.50
4	3.75	6.75
5	5.00	8.00
6	6.25	9.25
7	7.50	10.50
8	8.75	11.75
9	10.00	13.00
10	11.25	14.25
11	12.50	15.50
12	13.75	16.75
13	15.00	18.00
14	16.25	19.25
15	17.50	20.50

							General Tolerance	Zeakka Electronics				Document No.: ZK-1251WM		
							.X ±0.3					Title: HOUSING, MALE, CRIMP TYPE, SINGLE ROW, 1.25MM PITCH		
							.XX ±0.2					APPR	CH'K	DRWN
Date	Version	EC No.	Description	DRWN	CH'K	APPR	.XXX ±0.1	Kai Lee	Cris Wang	Jun Wei	2020.8.7	mm	1:1	A

THIRD ANGLE PROJECTION

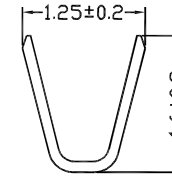
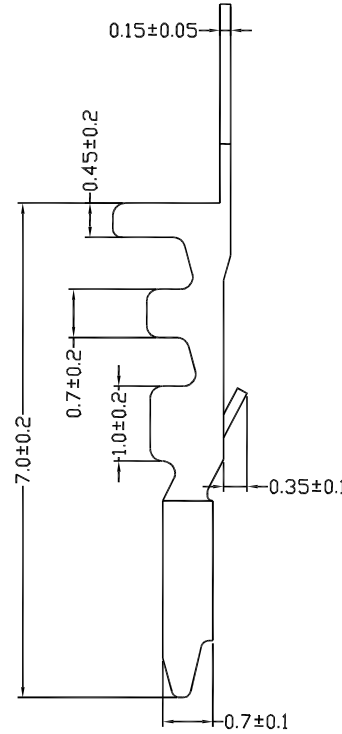
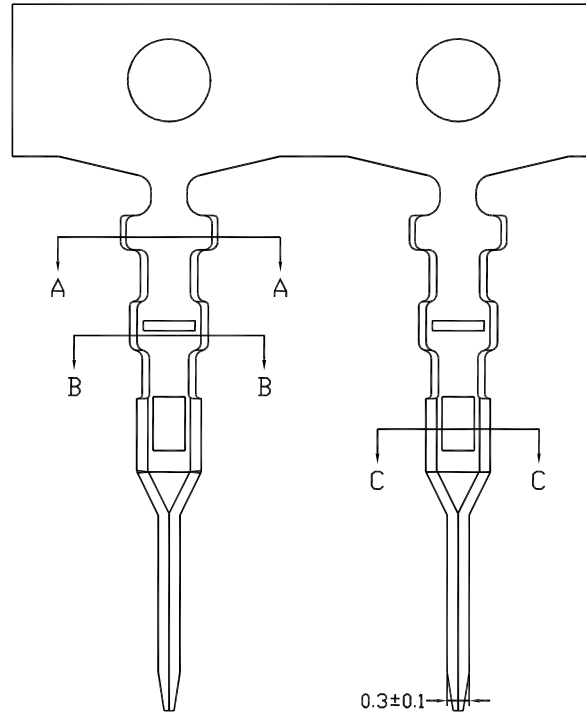

SECTION A-A

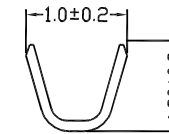

SECTION B-B

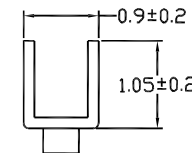

SECTION C-C

Specifications:

Current Rating: 1.0A AC/DC
 Voltage rating: 125V AC/DC
 Temperature range: -25°C to +85°C
 Contact resistance: 20mΩ max.
 Insulation resistance: 100M min.
 Withstand voltage: 500V AC/minute
 Applicable wire: AWG32 - AWG28
 Insulation OD: max 1.0mm
 Package: 20000pcs / reel

Material:

Phosphor bronze

Used with: 1251WM (male housing)

Part Number Information:

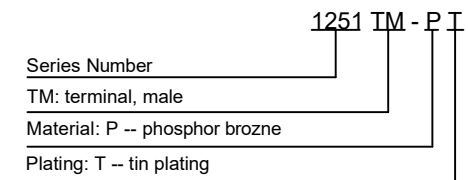

							General Tolerance	Zeakka Electronics				Document No.: ZK-1251TM						
							.X ±0.3					Title: TERMINAL, MALE, CRIMP TYPE, PHOSPHOR BRONZE, TIN, REEL						
							.XX ±0.2					APPR	CH'K	DRWN	Date	Dimensions	Scale	Version
							.XXX ±0.1					Kai Lee	Cris Wang	Jun Wei	2020.8.7	mm	1:1	A
Date	Version	EC No.	Description	DRWN	CH'K	APPR	THIRD ANGLE PROJECTION											